

Backing Rings

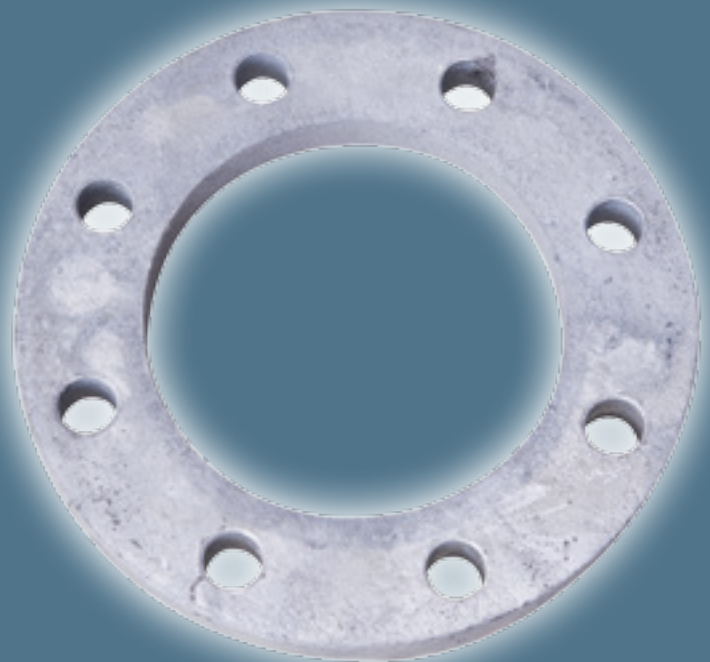
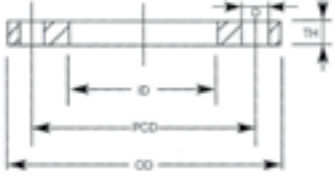

Backing Rings

BACKING RINGS GALVANISED STEEL - TABLE D

	Suit PE/Size (mm)	Flange Size (inch)	Code	OD (mm)	ID (mm)	PCD (mm)	TH (mm)	Qty Bolt Holes	D (mm)	Bolt Size (mm)	Weight (kg)
	110	4"	611101	215	125	178	10	4	18	M16	1.81
	125	4"	611201								
	140	5"									
	160	6"	611601	280	175	235	13	8	18	M16	3.62
	180	6"	611801	280	185	235	13	8	18	M16	3.33
	200	8"	612001	335	230	292	13	8	18	M16	4.55
	225	8"	612251	335	240	292	13	8	18	M16	4.17
	250	10"	612501	405	290	356	16	8	22	M20	7.50
	280	10"	612801	405	300	356	16	8	22	M20	6.92
	315	12"	613151	455	345	406	19	12	22	M20	9.63
	355	14"	613551	525	373	470	22	12	26	M24	17.41
	400	16"	614001	580	425	521	22	12	26	M24	20.03
	450	18"	614501	640	480	584	25	12	26	M24	26.37
	500	20"	615001	705	533	641	29	16	26	M24	36.14
	560	22"	615601	760	590	699	29	16	30	M27	38.46
	630	24"	616301	825	660	756	32	16	30	M27	45.50



BACKING RINGS GALVANISED STEEL - TABLE E

Suit PE/Size (mm)	Flange Size (inch)	Code	OD (mm)	ID (mm)	PCD (mm)	TH (mm)	Qty Bolt Holes	D (mm)	Bolt Size (mm)	Weight (kg)
20	1/2"	610201	95	32	67	6	4	14	M12	0.27
25	3/4"	610251	100	37	73	6	4	14	M12	0.29
32	1"	610321	115	44	83	7	4	14	M12	0.45
40	1 1/4"	610401	120	52	87	8	4	14	M12	0.54
50	1 1/2"	610501	135	62	98	9	4	14	M12	0.75
63	2"	610631	150	74	114	10	4	18	M16	0.97
75	2 1/2"	610751	165	87	127	10	4	18	M16	1.13
90	3"	610901	185	103	146	12	4	18	M16	1.65
110	4"	611102	215	125	178	13	8	18	M16	2.24
125	4"	611252	215	140	178	13	8	18	M16	1.93
125	5"	611251	255	140	210	14	8	18	M16	3.70
140	5"	611401	255	158	210	14	8	18	M16	3.23
160	6"	611602	280	175	235	17	8	22	M20	4.60
180	6"	611802	280	185	235	17	8	22	M20	4.22
200	8"	612002	335	230	292	19	8	22	M20	6.50
225	8"	612252	335	240	292	19	8	22	M20	5.95
250	10"	612502	405	290	356	22	12	22	M20	10.05
280	10"	612802	405	300	356	22	12	22	M20	9.25
315	12"	613152	455	345	406	25	12	26	M24	12.31
355	14"	613552	525	373	470	29	12	26	M24	22.95
400	16"	614002	580	425	521	32	12	26	M24	29.13
450	18"	614502	640	480	584	35	16	26	M24	36.33
500	20"	615002	705	533	641	38	16	26	M24	47.35
560	22"	615602	760	590	699	44	16	30	M27	58.35
630	24"	616302	825	660	756	48	16	33	M30	67.36

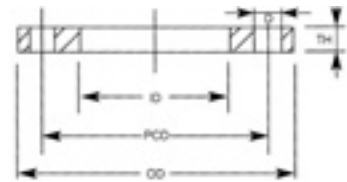

Backing Rings

BACKING RINGS GALVANISED STEEL - ANSI 150

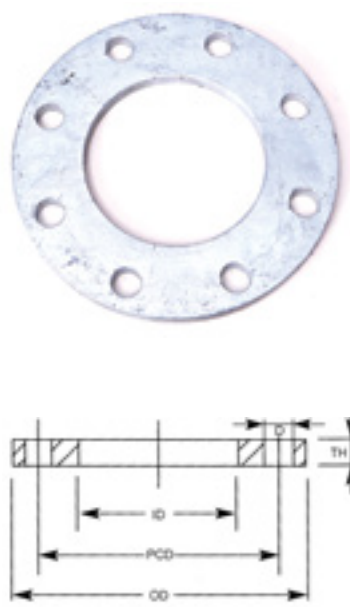
	Suit PE/Size (mm)	Flange Size (inch)	Code	OD (mm)	ID (mm)	PCD (mm)	TH (mm)	Qty Bolt Holes	D (mm)	Bolt Size (mm)	Weight (kg)
	20	1/2"	610203	90	32	60.5	6	4	16	M14	0.22
	25	3/4"	610253	98	37	70.0	8	4	16	M14	0.36
	32	1"	610323	108	44	79.5	8	4	16	M14	0.43
	40	1 1/4"	610403	117	52	89.0	8	4	16	M14	0.49
	50	1 1/2"	610503	127	62	98.5	10	4	16	M14	0.69
	63	2"	610633	152	74	120.5	10	4	20	M18	0.99
	75	2 1/2"	610753	178	87	139.5	10	4	20	M18	1.39
	90	3"	610903	191	103	152.0	12	4	20	M18	1.80
	110	4"	611103	229	125	190.5	12	8	20	M18	2.49
	125	5"	611253	254	140	216.0	16	8	22	M20	4.05
	140	5"	611403	254	158	216.0	16	8	22	M20	4.00
	160	6"	611603	279	175	241.0	16	8	22	M20	4.28
	180	6"	611803	279	185	241.0	16	8	22	M20	4.44
	200	8"	612003	343	230	298.5	20	8	22	M20	7.51
	225	8"	612253	343	240	298.5	20	8	22	M20	6.93
	250	10"	612503	406	290	362.0	20	12	26	M24	8.95
	280	10"	612803	406	300	362.0	20	12	26	M24	8.23
	315	12"	613153	483	345	432.0	25	12	26	M24	16.36
	355	14"	613553	535	376	476.0	28	12	29	M27	23.26
	400	16"	614003	600	430	540.0	32	16	29	M27	31.89
	450	18"	614503	635	480	578.0	36	16	32	M28.4	34.72
	500	20"	615003	700	533	635.0	40	20	32	M28.4	45.73
	560	22"	615603	750	590	692.0	46	20	35	M28.4	53.86
	630	24"	616303	825	660	756.0	32	20	30	M27	45.50

*ANSI 300 available on request.

Backing Rings

BACKING RINGS GALVANISED STEEL - DIN 16

Suit PE/Size (mm)	Flange Size (inch)	Code	OD (mm)	ID (mm)	PCD (mm)	TH (mm)	Qty Bolt Holes	D (mm)	Bolt Size (mm)	Weight (kg)
32	1"	630324	115	44	85	12	4	14	M12	0.78
40	1 1/4"	630404	140	52	100	14	4	18	M16	1.35
50	1 1/2"	630504	150	62	110	14	4	18	M16	1.50
63	2"	630634	165	74	125	16	4	18	M16	2.02
75	2 1/2"	630754	185	87	145	16	4	18	M16	2.37
90	3"	630904	200	103	160	18	8	18	M16	2.97
110	4"	631104	220	125	180	18	8	18	M16	3.35
125	4"	631254	220	140	180	18	8	18	M16	2.91
125	5"	631255	250	140	210	25	8	18	M16	6.21
140	5"	631404	250	158	210	18	8	18	M16	3.88
160	6"	631604	285	175	240	20	8	22	M20	5.76
180	6"	631804	285	185	240	20	8	22	M20	5.32
200	8"	632004	340	230	295	24	12	22	M20	8.42
225	8"	632254	340	240	295	24	12	22	M20	7.72
250	10"	632504	405	290	355	30	12	26	M24	13.28
280	10"	632804	405	300	356	30	12	22	M20	9.25
315	12"	633154	455	345	406	34	12	26	M24	12.31

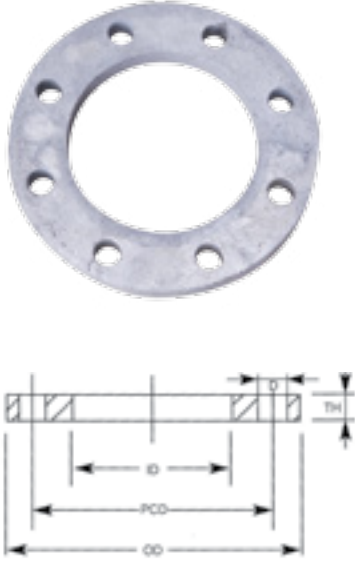

BACKING RINGS GALVANISED STEEL - DIN 10

Suit PE/Size (mm)	Flange Size (inch)	Code	OD (mm)	ID (mm)	PCD (mm)	TH (mm)	Qty Bolt Holes	D (mm)	Bolt Size (mm)	Weight (kg)
32	1"									
40	1 1/4"									
50	1 1/2"									
63	2"									
75	2 1/2"									
90	3"									
110	4"									
125	4"									
125	5"									
140	5"									
160	6"									
180	6"									
200	8"	642003	340	235	295	22	8	22	M20	7.66
225	8"	642253	340	238	295	22	8	22	M20	7.42
250	10"									
280	10"									
315	12"									

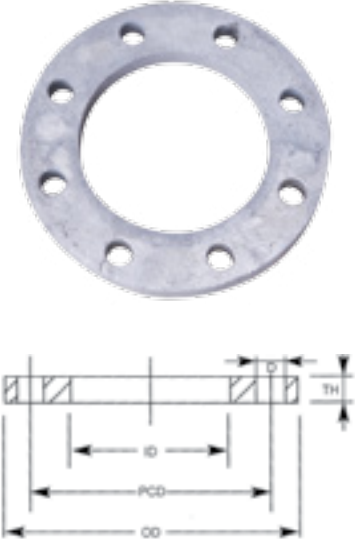

Backing Rings

BACKING RINGS 316 STAINLESS STEEL - TABLE D

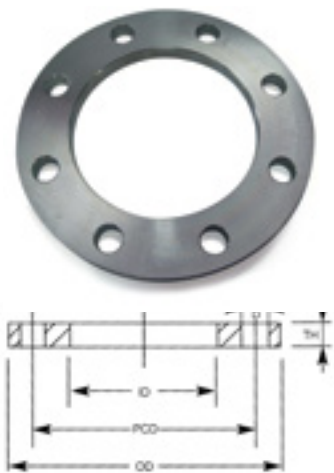
	Suit PE/Size (mm)	Flange Size (inch)	Code	OD (mm)	ID (mm)	PCD (mm)	TH (mm)	Qty Bolt Holes	D (mm)	Bolt Size (mm)	Weight (kg)
	110	4"	631101	215	140	178	13	4	18	M16	2.03
	125	4"	631251	215	140	178	13	4	18	M16	2.03
	125	5"									
	160	6"	631601								
	180	6"	631801								
	200	8"									
	225	8"	632251								
	250	10"	632501	405	290	356	16	8	22	M20	12.30
	280	10"	632801	405	300	356	16	8	22	M20	12.20
	315	12"	633151								
	355	14"	633551								

BACKING RINGS 316 STAINLESS STEEL - TABLE E

	Suit PE/Size (mm)	Flange Size (inch)	Code	OD (mm)	ID (mm)	PCD (mm)	TH (mm)	Qty Bolt Holes	D (mm)	Bolt Size (mm)	Weight (kg)
	20	1/2"	630201	95	32	67	8	4	14	M12	0.36
	25	3/4"	630251	100	37	73	8	4	14	M12	0.39
	32	1"	630321	115	44	83	8	4	14	M12	0.52
	40	1 1/4"	630401	120	52	87	8	4	14	M12	0.54
	50	1 1/2"	630501	135	62	98	8	4	14	M12	0.67
	63	2"	630631	150	74	114	8	4	18	M16	0.78
	75	2 1/2"	630751	165	87	127	10	4	18	M16	1.13
	90	3"	630901	185	103	146	10	4	18	M16	1.38
	110	4"	631102	215	125	178	13	8	18	M16	2.35
	125	4"	631252	215	140	178	13	8	18	M16	2.03
	125	5"	631253	255	140	210	13	8	18	M16	3.43
	160	6"	631602	280	175	235	14	8	22	M20	3.79
	180	6"	631802	280	185	235	14	8	22	M20	3.48
	200	8"	632002	335	230	292	16	8	22	M20	5.47
	225	8"	632252	335	230	292	16	8	22	M20	5.47
	250	10"	632502	405	290	356	16	12	22	M20	7.31
	280	10"	632802	405	300	356	16	12	22	M20	6.73
	315	12"	633152	455	345	406	18	12	22	M20	9.12
	355	14"	633552	525	373	470	20	12	26	M24	15.83

*Larger sizes available on request.

BACKING RINGS 316 STAINLESS STEEL - ANSI 150

Suit PE/Size (mm)	Flange Size (inch)	Code	OD (mm)	ID (mm)	PCD (mm)	TH (mm)	Qty Bolt Holes	D (mm)	Bolt Size (mm)	Weight (kg)
20	1/2"	620204	90	32	60.5	6	4	16	M14	0.22
25	3/4"	620254	98	37	70.0	8	4	16	M14	0.36
32	1"	620324	108	44	79.5	8	4	16	M14	0.43
40	1 1/4"	620404	117	52	89.0	8	4	16	M14	0.49
50	1 1/2"	620504	127	62	98.5	10	4	16	M14	0.69
63	2"	620634	152	74	120.5	10	4	20	M18	0.99
75	2 1/2"	620754	178	87	139.5	10	4	20	M18	1.39
90	3"	620904	191	103	152.0	12	4	20	M18	1.80
110	4"	621104	229	125	190.5	12	8	20	M18	2.49
125	4"	621254	229	140	190.5	12	8	22	M20	2.14
125	5"	621255	254	140	216.0	16	8	22	M20	4.05
140										
160	6"	621604	279	175	241.0	16	8	22	M20	4.28
180	6"	621804	279	185	241.0	16	8	22	M20	3.92
200	8"	622004	343	230	298.5	20	12	26	M24	6.98
225	8"	622254	343	240	298.5	20	12	26	M24	6.40
250	10"	622504	406	290	362.0	20	12	26	M24	8.95
280	10"	622804	406	300	362.0	20	12	26	M24	8.23
315	12"	623154	483	345	432.0	25	12	26	M24	16.36
355	14"	623554	535	376	476.0	28	12	29	M27	23.26

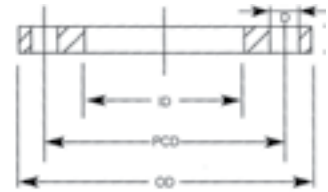

*Larger sizes available on request.



Backing Rings

CHINA PUMP FLANGES GALVANISED STEEL

	Suit PE/Size (mm)	Flange Size	Code	ID (mm)	Weight (kg)
	160 / 180	6" (150 mm)	651601	185	2.91
	200 / 225	8" (200 mm)	652001	230	4.08
	250 / 280	10" (250 mm)	652501	290	4.60
	315	12" (300 mm)	653151	345	7.11



BLIND FLANGES GALVANISED STEEL - TABLE D

Suit PE/Size (mm)	Flange Size	Code	Weight (kg)
160 / 180	6" (150 mm)	621601	6.40
200 / 225	8" (200 mm)	621001	8.72
250 / 280	10" (250 mm)	622501	15.80
450	18" (450 mm)	624501	61.88
500	20" (500 mm)	625001	86.93
560	22" (560 mm)	625601	100.70
630	24" (600 mm)	626301	131.44

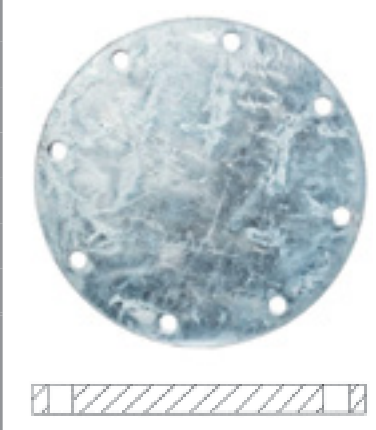

BLIND FLANGES GALVANISED STEEL - TABLE E

Suit PE/Size (mm)	Flange Size	Code	Weight (kg)
20	1/2" (15 mm)	620201	0.31
25	3/4" (20 mm)	620251	0.34
32	1" (25 mm)	620321	0.54
40	1 1/4" (30 mm)	620401	0.67
50	1 1/2" (40 mm)	620501	0.96
63	2" (50 mm)	620631	1.31
75	2 1/2" (65 mm)	620751	1.60
90	3" (80 mm)	620901	2.43
110 / 125	4" (100 mm)	621102	3.49
125 / 140	5" (125 mm)	621252	3.50
160 / 180	6" (150 mm)	621602	7.81
200 / 225	8" (200 mm)	622002	12.70
250 / 280	10" (250 mm)	622502	21.46
315	12" (300 mm)	623152	30.66
355	14" (355 mm)	623552	47.83
400	16" (400 mm)	624002	64.77
450	18" (450 mm)	624502	86.05
500	20" (500 mm)	625002	113.91
560	22" (560 mm)	625602	152.78
630	24" (600 mm)	626302	196.27

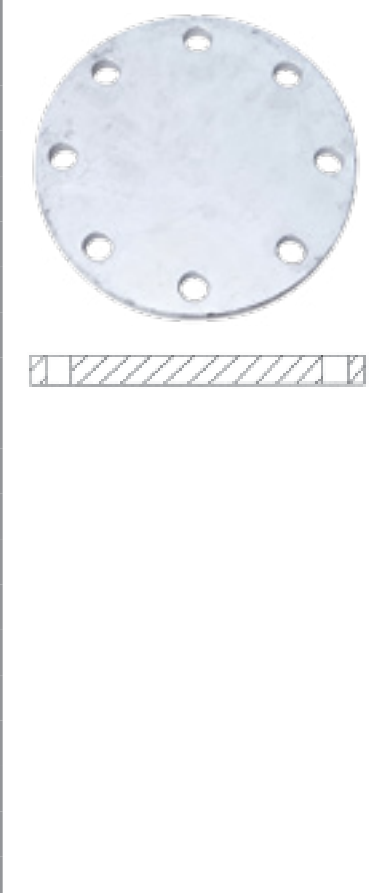

Backing Rings

BLIND FLANGES GALVANISED STEEL - ANSI 150

	Suit PE/Size (mm)	Flange Size	Code	Weight (kg)
	20	1/2" (15 mm)	620203	0.26
	25	3/4" (20 mm)	620253	0.43
	32	1" (25 mm)	620323	0.53
	40	1 1/4" (30 mm)	620403	0.62
	50	1 1/2" (40 mm)	620503	0.93
	63	2" (50 mm)	620633	1.33
	75	2 1/2" (65 mm)	620753	1.86
	90	3" (80 mm)	620903	2.58
	110 / 125	4" (100 mm)	621103	3.65
	125 / 140	5" (125 mm)	621253	5.98
	160 / 180	6" (150 mm)	621603	7.30
	200 / 225	8" (200 mm)	622003	14.03
	250 / 280	10" (250 mm)	622503	19.33
	315	12" (300 mm)	623153	34.71
	355	14" (355 mm)	623553	47.67
	400	16" (400 mm)	624003	68.37
	450	18" (450 mm)	624503	85.86
	500	20" (500 mm)	625003	115.79
	560	22" (560 mm)	625603	152.58
	630	24" (600 mm)	626303	196.20

BLIND FLANGES 316 STAINLESS STEEL - TABLE D

Suit PE/Size (mm)	Flange Size	Code	Weight (kg)	
20	1/2" (15 mm)			
25	3/4" (20 mm)			
32	1" (25 mm)			
40	1 1/4" (30 mm)			
50	1 1/2" (40 mm)			
63	2" (50 mm)			
75	2 1/2" (65 mm)			
90	3" (80 mm)			
110 / 125	4" (100 mm)			
125 / 140	5" (125 mm)			
160 / 180	6" (150 mm)			
200 / 225	8" (200 mm)			
250 / 280	10" (250 mm)	628004	19.34	
315	12" (300 mm)			
355	14" (355 mm)			

BLIND FLANGES 316 STAINLESS STEEL - TABLE E

Suit PE/Size (mm)	Flange Size	Code	Weight (kg)	
20	1/2" (15 mm)	620207	0.40	
25	3/4" (20 mm)	620257	0.45	
32	1" (25 mm)	620327	0.61	
40	1 1/4" (30 mm)	620407	0.67	
50	1 1/2" (40 mm)	620507	0.86	
63	2" (50 mm)	620637	1.07	
75	2 1/2" (65 mm)	620757	1.60	
90	3" (80 mm)	620907	2.03	
110 / 125	4" (100 mm)	621107	3.60	
125 / 140	5" (125 mm)	621257	5.00	
160 / 180	6" (150 mm)	621607	6.44	
200 / 225	8" (200 mm)	622007	14.04	
250 / 280	10" (250 mm)	622507	12.30	
315	12" (300 mm)	623157	34.73	
355	14" (355 mm)	623557	47.07	

Backing Rings

BLIND FLANGES 316 STAINLESS STEEL - ANSI 150

	Suit PE/Size (mm)	Flange Size	Code	Weight (kg)
	20	1/2" (15 mm)	640204	0.26
	25	3/4" (20 mm)	640254	0.42
	32	1" (25 mm)	640324	0.53
	40	1 1/4" (30 mm)	640404	0.63
	50	1 1/2" (40 mm)	640504	0.93
	63	2" (50 mm)	640634	1.33
	75	2 1/2" (65 mm)	640754	1.86
	90	3" (80 mm)	640904	2.58
	110 / 125	4" (100 mm)	641104	3.64
	140	5" (125 mm)	641404	6.00
	160 / 180	6" (150 mm)	641604	7.30
	200 / 225	8" (200 mm)	642004	14.04
	250 / 280	10" (250 mm)	642504	19.34
	315	12" (300 mm)	643154	34.73
	355	14" (355 mm)	643554	47.70