

# Sapiens



## Blue Seal Gas Combi Steamer SAPIENS G10SDW 10 x 1/1 GN



- Manual controls
- Multi-point core temperature probe
- High visibility display
- Two speed fan
- 90 preset recipe programs
- 99 free programs with 4 cycles, automatic sequence
- Multiprogram keypad for quick, "press and go" program selection with nine positions
- Electronic thermostat 30° - 300°C
- Auto-reversing fan rotation
- Autoclima with automatic vent
- Built-in retractable hand shower with tap
- SCS (Solid Clean System) automatic cleaning system with built in tank and automatic detergent dispenser
- 4 LED's to indicate actual cooking cycle in programme mode
- ECOVAPOR - automatic control of the steam saturation in the cooking chamber
- ECOSPEED - oven optimises and controls the delivery of energy to maintain correct cooking temperature
- Fast-Dry, quick dehumidification of the cooking chamber
- USB connection

### GENERAL FEATURES:

- Direct steam injection system
- High efficiency heat exchanger and gas burner system
- Stainless steel construction
- Perfectly smooth, water tight chamber
- Adjustable door hinge for optimal seal
- Halogen oven light
- Oven door handle mechanism allows either left or right operation
- Cool to touch door with double tempered glass with air chamber and interior heat-reflective glass

- Hinged inner glass for easy cleaning
- Constant self-diagnosis for error recognition
- IPX5 spray-proof and hose proof
- Rack runners for GN loading

### OPTIONAL FEATURES

- Right hinged door
- Side runners for 600 x 400 trays
- Configuration for connection to extraction hood



ECOVAPOR



ECOSPEED



AUTOCLIMA



FAST-DRY



GREEN FINE TUNING



SOI ID CI FAN

# Sapiens

## Blue Seal Gas Combi Steamer SAPIENS G10SDW 10 x 1/1 GN

### Dimensions

Width	930mm
Depth	825mm
Height	1040mm
Weight	180kg

### Packed Dimensions

Width	1040mm
Depth	980mm
Height	1250mm
Weight	205kg

### Shelves

1/1 GN	10
Shelf Spacings	70mm

### Installation requirements

(for precise installation instructions, please refer to the unit's installation manual).

### Power connection requirements

230-240V, 50Hz, 1P+N+E  
Supply line voltage: 1.0 kW  
Electrical power: 4.2 A  
Rated current: 3 pin plug (10A) cordset fitted

### Gas Connection

Nominal gas consumption:  
71 MJ/hr

Gas connection size: R $\frac{1}{2}$

Exhaust connection to ventilation system with safety switch.

Observe regulations for gas suppliers.

### Installation clearances

- rear 25mm
- right 500mm\*
- left 50mm

\*Clearance required on fixed installations for service accessibility.

If heat sources are located near the RH side of the Sapiens combi, ensure that a minimum distance of 400mm is maintained.

Install in accordance with local body regulations only on horizontal surfaces and not against combustible walls.

### Water connection requirements

- cold water
- flow pressure (200-500kPa)
- soft water connection\*
- shut-off valve with return flow inhibitor and dirt filter
- water supply R $\frac{3}{4}$
- R50 waste water connection

(\*Water softener may be required. Please refer to installation manual for water treatment values.)

Australia  
[www.moffat.com.au](http://www.moffat.com.au)

New Zealand  
[www.moffat.co.nz](http://www.moffat.co.nz)

Australia  
Moffat Pty Limited

Victoria/Tasmania  
740 Springvale Road  
Mulgrave, Victoria 3170  
Ph 03-9518 3888  
Fax 03-9518 3833  
[vsales@moffat.com.au](mailto:vsales@moffat.com.au)  
[www.moffat.com.au](http://www.moffat.com.au)

New South Wales  
Ph 02-8833 4111  
[nswsales@moffat.com.au](mailto:nswsales@moffat.com.au)

South Australia  
Ph 03-9518 3888  
[vsales@moffat.com.au](mailto:vsales@moffat.com.au)

Queensland  
Ph 07-3630 8600  
[qldsales@moffat.com.au](mailto:qldsales@moffat.com.au)

Western Australia  
Ph 08-9202 6820  
[bgarcia@moffat.com.au](mailto:bgarcia@moffat.com.au)

New Zealand  
Moffat Limited

Christchurch  
16 Osborne Street  
Christchurch 8011  
Ph +64 3-389 1007  
Fax +64 3-389 1276  
[sales@moffat.co.nz](mailto:sales@moffat.co.nz)

Auckland  
Ph +64 9-574 3150  
[sales@moffat.co.nz](mailto:sales@moffat.co.nz)

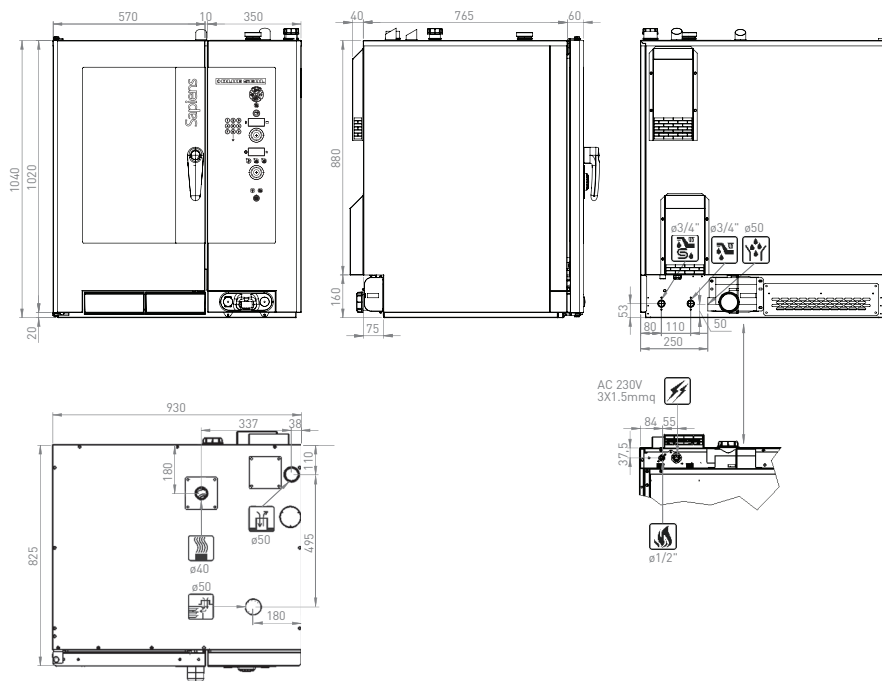

In line with policy to continually develop and improve its products, Moffat Limited reserves the right to change specifications and design without notice.

© Copyright Moffat Ltd  
Moffat 7.14 / 1413