

Blue Seal Gas Combi Steamer SAPIENS G21SDW 20 x 1/1 GN



- Manual controls
- Multi-point core temperature probe
- High visibility display
- Two speed fan
- 90 preset recipe programs
- 99 free programs with 4 cycles, automatic sequence
- Multiprogram keypad for quick, "press and go" program selection with nine positions
- Electronic thermostat 30° - 300°C
- Auto-reversing fan rotation
- Autoclimate with automatic vent
- Built-in retractable hand shower with tap
- LM automatic cleaning system with separate container for CombiClean liquid detergent
- 4 LED's to indicate actual cooking cycle in programme mode
- ECOVAPOR - automatic control of the steam saturation in the cooking chamber
- ECOSPEED - oven optimises and controls the delivery of energy to maintain correct cooking temperature
- Fast-Dry, quick dehumidification of the cooking chamber
- USB connection

GENERAL FEATURES:

- Direct steam injection system
- High efficiency heat exchanger and gas burner system
- Stainless steel construction
- Perfectly smooth, water tight chamber
- Adjustable door hinge for optimal seal
- Door with 3 locking points
- Halogen oven light
- Oven door handle mechanism allows either left or right operation
- Cool to touch door with double tempered glass with air chamber and interior heat-reflective glass

- Hinged inner glass for easy cleaning
- Constant self-diagnosis for error recognition
- IPX5 spray-proof and hose proof
- Rack runners for GN loading

OPTIONAL FEATURES

- Right hinged door
- Trolley for 600 x 400 trays
- Configuration for connection to extraction hood



ECOVAPOR



ECOSPEED



AUTOCLIMA



FAST DRY



GREEN FINE TUNING

Blue Seal Gas Combi Steamer SAPIENS G21SDW 20 x 1/1 GN

Dimensions

Width	960mm
Depth	825mm
Height	1810mm
Weight	290kg

Packed Dimensions

Width	1130mm
Depth	1050mm
Height	2060mm
Weight	400kg

Shelves

1/1 GN	20
Shelf Spacings	63mm

Installation requirements

(for precise installation instructions, please refer to the unit's installation manual).

Power connection requirements

230-240V, 50Hz, 1P+N+E
Supply line voltage: 1.8 kW
Electrical power: 7.8 A
Rated current: 3 pin plug (10A) cordset fitted

Gas Connection

Nominal gas consumption:
142 MJ/hr
Gas connection size: R $\frac{3}{4}$

Exhaust connection to ventilation system with safety switch.

Observe regulations for gas suppliers.

Installation clearances

- rear	25mm
- right	500mm*
- left	50mm

*Clearance required on fixed installations for service accessibility.

If heat sources are located near the RH side of the Sapiens combi, ensure that a minimum distance of 400mm is maintained.

Install in accordance with local body regulations only on horizontal surfaces and not against combustible walls.

Water connection requirements

- cold water
- flow pressure (200-500kPa)
- soft water connection*
- shut-off valve with return flow inhibitor and dirt filter
- water supply R $\frac{3}{4}$
- R50 waste water connection

(*Water softener may be required. Please refer to installation manual for water treatment values.)

MOFFAT

Australia
www.moffat.com.au

New Zealand
www.moffat.co.nz

Australia
Moffat Pty Limited

Victoria/Tasmania
740 Springvale Road
Mulgrave, Victoria 3170
Ph 03-9518 3888
Fax 03-9518 3833
vsales@moffat.com.au
www.moffat.com.au

New South Wales
Ph 02-8833 4111
nswsales@moffat.com.au

South Australia
Ph 03-9518 3888
vsales@moffat.com.au

Queensland
Ph 07-3630 8600
qldsales@moffat.com.au

Western Australia
Ph 08-9202 6820
bgarcia@moffat.com.au

New Zealand
Moffat Limited

Christchurch
16 Osborne Street
Christchurch 8011
Ph +64 3-389 1007
Fax +64 3-389 1276
sales@moffat.co.nz

Auckland
Ph +64 9-574 3150
sales@moffat.co.nz

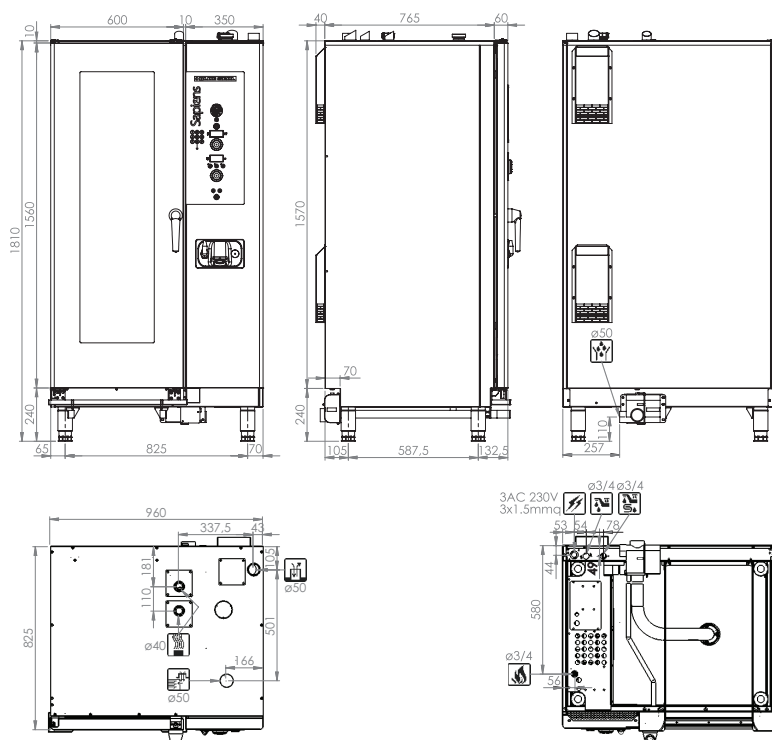

Electric power supply cable inlet



Steam vent and chamber pressure drop safety device



Air extraction



Softened water inlet



Gas inlet and type of thread



Flue pipe



Normal water inlet



Liquid outlet

In line with policy to continually develop and improve its products, Moffat Limited reserves the right to change specifications and design without notice.

© Copyright Moffat Ltd
Moffat 7.14 / 1413