

# XL

## Economy Heavy Duty Passthrough Dishwasher – 500mm Rack W 750mm x D 765mm x H 1525mm

The Washtech XL is fitted with heavy duty stainless componentry, excellent filtration systems, and the most powerful wash pump in the standard Washtech range. This durable and powerful passthrough dishwasher is ideal for tough jobs in the busiest of kitchens.

Staying true to the original and reliable Washtech electromechanical control design and equipped with a shortest cycle of 40 seconds, the XL is a reliable option for busy establishments requiring an easy to use, simple to service machine that provides exceptional wash results in very rapid cycle times.

### Standard Features

- Autostart on door closure 40, 60 and 90 second cycles
- Washes up to 1,620 plates per hour
- Easy installation supplied complete with:
  - Water supply hose
  - Detergent pump with injector lines
  - No commissioning required
- Reliable results through robust stainless steel wash and rinse arms with precision stainless steel jets
- Easily serviced electromechanical design
- Durable stainless steel construction
- Low hot water consumption of 2.6 litres per cycle
- Moffat's Comprehensive 5-2-1 Warranty

### Includes:

- 2 x 600 70028 – 500mm dish rack
- 1 x 600 70029 – 500mm cup rack
- 1 x C660503 – cutlery container
- 1 x C660508 – cutlery basket



## XL

Economy Heavy Duty Passthrough Dishwasher

– 500mm Rack

W 750mm x D 765mm x H 1525mm

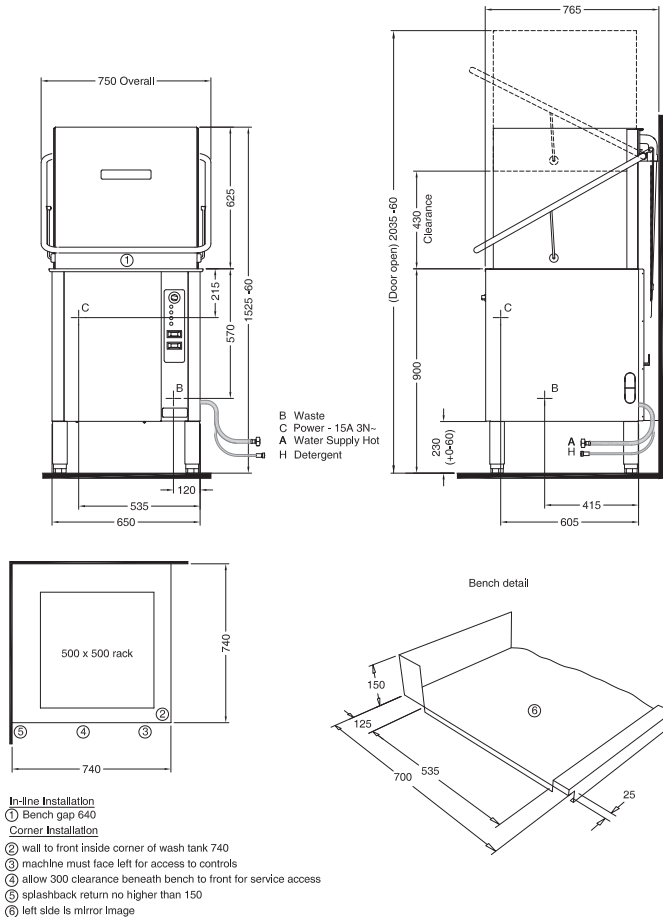

<b>A Hot Water</b>	
Temperature	65°C
Connection	3/4" male hose supplied
Pressure	200-350kPa
Flow	20 litres per min
Quality	Potable & soft
Backflow Prevention	Dual Check Valve (DCV)
Consumption	2.6 litres per cycle

<b>B Waste</b>	
Connection	1.5 BSP
Line	2" BSP

<b>C Electrical</b>	
Three phase	415V 50Hz 15A/phase
<b>Maximum Power Consumption</b>	
Three phase	9.0kW
<b>Heating</b>	
Wash	2.5kW
Rinse	6.0kW

<b>Dimensions</b>	
Width	750mm
Depth	765mm
Height	1525mm
Weight	120kg

<b>Packed Dimensions</b>	
Width	800mm
Depth	950mm
Height	1475mm
Weight	141kg
Cubicmetres	1.1m³

<b>Water Quality Requirements</b>							
Hardness	ppm	pH					
Min	20	7					
Max	100	8					
Ions	CL-	SO <sub>4</sub>	Fe	Mn	Cu	CL <sub>2</sub>	
Max mg/l	100	400	0.1	0.5	0.05	0.1	

Refer operator manual for installation instructions



**MOFFAT®**

moffat.com.au

Australia  
Moffat Pty Limited

Victoria/Tasmania  
740 Springvale Road  
Mulgrave, Victoria 3170  
Telephone 03-9518 3888  
Facsimile 03-9518 3833  
vsales@moffat.com.au  
www.moffat.com.au

New South Wales  
Telephone 02-8833 4111  
nswsales@moffat.com.au

South Australia  
Telephone 03-9518 3888  
vsales@moffat.com.au

Queensland  
Telephone 07-3630 8600  
qldsales@moffat.com.au

Western Australia  
Telephone 08-9202 6820  
bgarcia@moffat.com.au

**ISO9001**  
All Washtech products are designed and manufactured by Washtech using the internationally recognised ISO9001 quality management system, covering design, manufacture and final inspection, ensuring consistent high quality at all times.

In line with policy to continually develop and improve its products, Washtech reserves the right to change specifications and design without notice.



© Copyright Moffat Ltd  
Moffat / 11.16

an Ali Group Company



The Spirit of Excellence