



Electrolux

**Modular Cooking Compact Line
Gas Pasta Cooker 6.5 gal.**

ITEM # _____

MODEL # _____

NAME # _____

SIS # _____

AIA # _____



Electrolux



**Modular Cooking Compact Line
Gas Pasta Cooker 6.5 gal.**

169024 (ACPG16)

GAS PASTA COOKER
6.5 GALLONS (24.5 liters)

Short Form Specification

Item No. _____

Unit to be Electrolux Gas Pasta Cooker with single high efficiency 42,500 BTU (12.5 kW) burner and single well with maximum capacity of 6.5 gal. (24.5 l). Suitable for natural gas or propane gas. Control panel with gas cock and water tap. Door to protect gas and water connections and to provide access to gas ignition and water drain valve. The tank is pressed in AISI 316L Stainless Steel to protect against corrosion. Worktop in AISI 304 Stainless Steel, 2mm thick. Front and side panels in Stainless Steel with Scotch Brite finish. Special heavy duty chrome plated knobs for durability and easy cleaning. The configuration of bezels and knobs provides high level of protection against water infiltrations. Right-angled side edges to allow flush fitting joints between units. Supplied with 6" (150mm) height adjustable legs.

Main Features

- Single high efficiency gas 12.5 kW burner.
- Burner with optimized combustion and protected pilot light.
- Flame failure device to protect against accidental extinguishing of the flame.
- Insulated cooktop to conserve energy.
- Easy-to-use control panel with gas cock and water tap.
- Door to protect gas and water connections and to provide access to gas ignition and water drain valve.
- All major compartments located in front of unit for ease of maintenance.
- In addition to cooking pasta, the appliance can be used for noodles of every kind, rice, dumplings, vegetables and soups for large or small servings.
- Water basin in AISI 316L Stainless Steel has a maximum capacity of 24.5 l and is seamlessly welded into the top of the appliance.
- Worktop in 304 AISI stainless steel, 2mm thick.
- Front and side panels in Stainless Steel with Scotch Brite finish.
- Special heavy duty chrome plated knobs for durability and easy cleaning.
- The configuration of bezels and knobs provides high level of protection against water infiltrations.
- Right-angled side edges to allow flush fitting joints between units, eliminating gaps and possible dirt traps.
- Provided with kit for side-by-side connection between units for minimizing gaps and possible dirt traps.
- Supplied with 150 mm height adjustable, removable legs.
- Included Accessories: propane converter kit, pressure regulator and main shut off valve.

Construction

- Worktop in 304 AISI stainless steel.

Optional Accessories

- Support frame for 4 baskets for 24,5lt pasta cookers PNC 921606
- 2 half size baskets 170x220 for 24,5lt pasta cookers PNC 921610
- 4 baskets 105x160 for 24,5lt pasta cookers (921606 must be ordered together) PNC 921618

APPROVAL: _____



Electrolux

Modular Cooking Compact Line Gas Pasta Cooker 6.5 gal.

Front

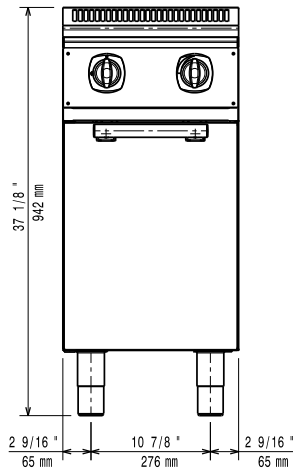

Top

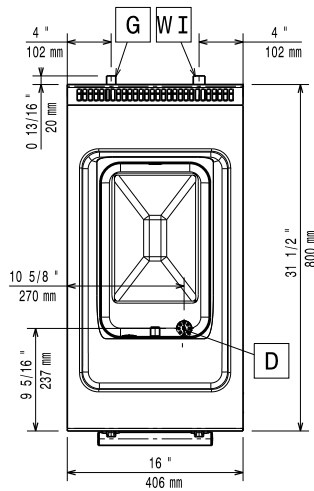

- CWI** = Cold Water inlet
- D** = Drain
- G** = Gas connection

Side

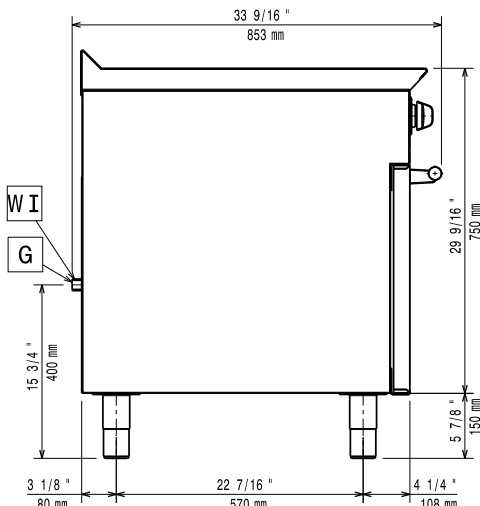

Gas

Gas Power:	
169024(ACPG25)	42500 Btu/hr (12.5 kW)
Gas Inlet:	3/4" NPT
Natural gas - Pressure:	3" w.c. (7 mbar)
LPG Gas Pressure:	7" w.c. (17.4 mbar)

Water:

Drain "D":	1"
Incoming Cold Water line size:	3/4"
Total hardness:	5-50 ppm

Electrolux recommends the use of treated water, based on testing of specific water conditions.
Please refer to user manual for detailed water quality information.

Key Information:

Usable well dimensions (width):	9 13/16" (250 mm)
Usable well dimensions (depth):	15 3/4" (400 mm)
Usable well dimensions (height):	11 13/16" (300 mm)
Well Capacity (MAX):	6.47 gal (24.5 litres) MAX
Net weight:	84 lbs (38 kg)
Shipping width:	18 11/16" (474 mm)
Shipping depth:	36 1/8" (918 mm)
Shipping height:	45 7/16" (1154 mm)
Shipping weight:	99 lbs (45 kg)
Shipping volume:	17.73 ft ³ (0.5 m ³)

*The rear and side clearances shown on the diagram indicate the minimum distances recommended from the appliance to combustible surfaces.

**Modular Cooking Compact Line
Gas Pasta Cooker 6.5 gal.**

The company reserves the right to make modifications to the products without prior notice. All information correct at time of printing.

