

## CLEVELAND KET-T SERIES

### ELECTRIC TABLE TOP KETTLES

Electric, self contained, tilting single kettle, 23 or 45 litre capacity, 2/3 steam jacketed. Solid state controls for accurate temperature control ( $\pm 1^{\circ}\text{C}$ ) and low water safety. All exterior surfaces are stainless steel.

Model: **KET-6-T (23lt capacity)**  
**KET-12-T (45lt capacity)**



#### STANDARD FEATURES

- Manual tilting, balanced design
- 50 psi steam jacket rating for higher cooking temperatures
- Solid state water level control
- Water resistant controls, splash-proof construction
- Welded-in heating elements
- Steam jacket filled with treated water, venting and/or refilling is not required
- Re-inforced rolled rim design prevents damage to kettle rim, eliminates "bar rim designs"
- Easily cleaned: kettle and all exterior surfaces are of type 304 stainless steel with an #4 finish
- Self locking marine type tilting mechanism prevents accidental spills. Balanced design makes it easy to tilt
- Accurate, consistent solid state temperature controls (mechanical thermostat not as accurate) - less than  $\pm 1^{\circ}\text{C}$  variance (ideal for simmering). Operating temperature range from  $63^{\circ}\text{C}$  -  $127^{\circ}\text{C}$  Control panel includes: LED indicator for heat cycle, LED indicator for low water, Power ON/OFF switch, Adjustable temperature control dial
- Rear mounted easy access pressure gauge and pressure relief valve to prevent tampering. Colour coded easy to read pressure gauge with "green" and "vent air zone"
- Self-contained, easily installed
- 50 psi safety valve
- Splash proof element cover with a double gasket seal
- Large pouring lip for high capacity and chunky products.

#### OPTIONAL FEATURES

- Stainless Steel Equipment Stand with Drain Drawer 450mm height. (ST-28)
- Optional Splash Guard for equipment stand. (SG-28)
- Hot and cold water faucet with swing spout. (DPK9)
- Cooking Baskets (BS)
- Food Strainers (FS)
- Measuring Strips (MS)
- Lift Off Cover (CL)
- Kettle Markings (KM)
- 316 Stainless Steel kettle liner for high acid food products (316-G)

SPECIFICATIONS ARE SUBJECT TO CHANGE WITHOUT NOTICE.

*From the world of Comcater!*

**National Head Office**  
 156 Swann Drive  
 Derrimut VIC 3030  
 Tel: +61 3 8369 4600  
 Fax: +61 3 8369 4695

**Melbourne**  
 96-100 Tope Street,  
 South Melbourne VIC 3205  
 Tel: +61 3 8369 4600  
 Fax: +61 2 8699 1299

**Sydney**  
 20/4 Avenue of the Americas  
 Newington, NSW 2127  
 Tel: +61 2 9748 3000  
 Fax: +61 2 9 648 4762

**Brisbane**  
 1/62 Borthwick Avenue  
 Murarrie QLD 4172  
 Tel: +61 7 3399 3122  
 Fax: +61 7 3399 5311

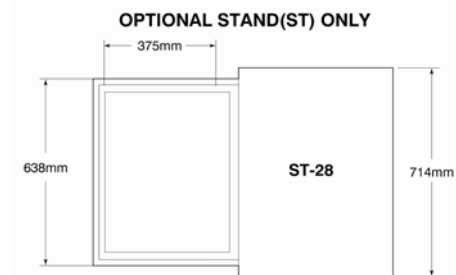
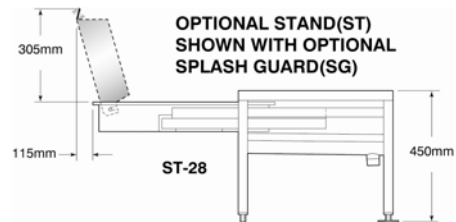
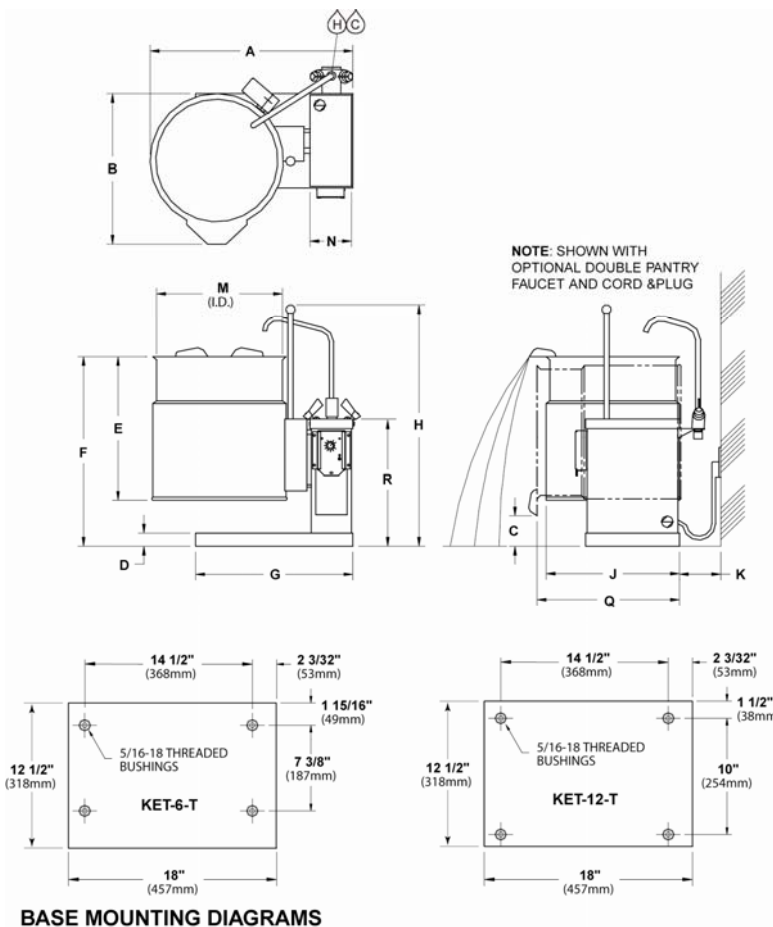

**DIMENSIONS (mm)**

Lt.	A	B	C	D	E	F	G	H	J	K	L	M	N	Q	R
<b>23</b>	610	432	165	38	419	572	457	724	394	152	864	337	152	438	432
<b>45</b>	669	508	178	38	486	632	457	864	406	152	965	425	152	457	432

**TECHNICAL DATA**

Power Supply	415V, 3 Phase, 10.5 amp (KET-6-T) 415V, 3 Phase, 16.7 amp (KET-12-T)
Energy Rating	8.2kW (KET-6-T) 13kW (KET-12-T)

SPECIFICATIONS ARE SUBJECT TO CHANGE WITHOUT NOTICE.



www.comcater.com.au

PROUDLY DISTRIBUTED BY: