



DESMON
Professional Refrigeration

Coolrooms



DESMON | MODULAR COOLROOM

Desmon extensive range of coolrooms are not only quick and easy to install (by interlocking panels with double Action 'Camlock' design), but are also versatile and extremely efficient to run. With more than 50 different size and combinations there is a size to suit most specifications. The panels are made from 80mm polyurethane insulation, (CFC & HCFC Free panel construction), which equates to a substantial 20% reduction in running costs from standard run-of-the-mill coolrooms currently available on the market.

Desmon sealed "straddle" refrigeration units are available for both for cooling and freezing applications. Because they are a sealed unit, the need to contract a qualified refrigeration technician is not always required. (Desmon also has a range of Remote units available to suit any layout or configuration).

There is a coolroom size to suit your needs:

♦ **Volume Capacity; ranging from 3.5m³ to 21m³**
[floor areas: from 1.8m² to 15m²]

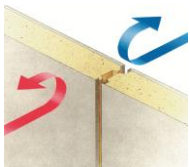

Unique "Cam-Lock" design

Desmon coolrooms, unlike other modular coolrooms on the market, our coolrooms are designed with unique male/female interlocking panels, meaning that you get a perfect seal every time. In approximately 2 hours you can have your coolroom installed and ready for use. No need for on-site cutting of panels, silicone gaps and joints nor the use of screws or rivets is necessary.

