

Dynamic SMX Range

SMX
range
HEAVY DUTY
MODELS

The ultimate power! Our super mixers in our SMX line, from the SMX 600 E to our newest SMX 800 DSC, offer the ultimate in performance and power. Our new cooling technology ensures longer life to your mixer.

01 SMX 600 E Non-detachable

Ref. MX002



15 - 50
gallons

Total length	800 mm / 31.5"
Mixer tool length	530 mm / 21"
Diameter	125 mm / 5"
Actual weight / shipping weight	6,1 Kg / 13,4 lbs - 7,7 kg / 17 lbs
Voltage	115 V or 230 V
Output	650 W
Speed	9000 R.P.M.

02 SMX 800 E Detachable

Ref. MX001



15 - 75
gallons



Total length	950 mm / 37.5"
Mixer tool length	680 mm / 27"
Diameter	125 mm / 5"
Actual weight / shipping weight	6,7 Kg / 14,7 lbs - 8,2 kg / 18 lbs
Voltage	115 V ou 230 V
Output	800 W
Speed	9000 R.P.M.

03 SMX 600 DSC Detachable

Ref. MX035



15 - 50
gallons

Total length	870 mm / 34.25"
Mixer tool length	600 mm / 24"
Diameter	125 mm / 5"
Actual weight / shipping weight	6,5 Kg / 14,3 lbs - 8,0 kg / 17,6 lbs
Voltage	115 V ou 230 V
Output	650 W
Speed	9000 R.P.M.

Dyna Speed Control

◀ **Convenient and secure** : Wall storage bracket for SMX and DSC included.

Dyna Speed Control

The DSC system regulates the speed of the mixer automatically depending on the product texture.



9000 R.P.M.



9000 R.P.M.

Mixer support bracket. For a safe and secure work environment (page 22).





04 SMX 800 DSC Detachable

Ref. MX034



15 - 75 gallons

Total length	950 mm / 37.5"
Mixer tool length	680 mm / 27"
Diameter	125 mm / 5"
Actual weight / shipping weight	6,7 Kg / 14,7 lbs - 8,2 kg / 18 lbs
Voltage	115 V or 230 V
Output	800 W
Speed	9000 R.P.M.

05 PP 97 Ricer / Foodmill

Ref. PP001

Non-detachable 520 mm / 20,5"

06 PP 97 Ricer / Foodmill Plus

Ref. PP002

Detachable 570 mm / 22,5"



Total length (PP97 / PP97+)	870 mm - 34" / 920 mm - 36"
Mixer tool length (PP97 / PP97+)	520 mm - 20,5" / 570 mm - 22,5"
Diameter	170 mm / 6,75"
Actual weight / shipping weight	4,9 kg / 10,7 lbs - 5,9 kg / 13 lbs
Voltage	115 V or 230 V
Output	460 W
Speed PP97 / PP97 Plus	500 R.P.M. / 100 - 500 R.P.M.

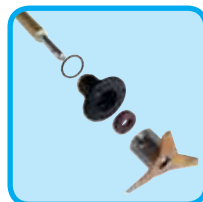

- Easily dismantled without any special tool.
- Reinforced seal (attached double lip), specially coated lines with anti-oxidation (anodizing).



Accessories available sold separately :

BM 97 Motor block only

Ref. AC221

460 watts BM 97 : Length : 350 mm / 14". 500 R.P.M. / Shipping Weight : 3.0 kg / 6.6 lbs.

AP 97 Ricer tool

Ref. AC220

Capacity : 30 kg / 70 lbs. Length : 450 mm / 18". Weight : 1,9 Kg / 4,2 lbs.

07 FM 97 Whisk tool - 720 mm / 28"

Ref. AC208

Comes with handle, capacity 40 to 100 litres / 10 to 25 gallons. Weight : 1,5 Kg / 3,3 lbs.

