

Technical data sheet for
GAS COOKTOPS 300mm
G512D-B, G512C-B

- Heavy-duty construction
- 28 MJ/hr open burners
- Flame failure standard
- Pilot burners optional
- 300mm griddle plate option
- Optional simmer plates
- Stainless steel exterior
- Easy clean
- Easy service
- Fully modular



G512D-B

Overall Construction

Cooktop

- Welded hob with 1.5mm 304 stainless steel bull nose
- Side panels 1.2mm 304 stainless steel
- Splashback 1.2mm 304 stainless steel
- Vitreous enamelled control panel
- Aluminised steel internal construction
- Cast iron 28MJ/hr open burners with forged brass cap
- Vitreous enamelled cast iron potstands
- Vitreous enamelled open burner spill cover
- Cast iron simmer plates (optional extra)
- 12mm thick mild steel griddle plate
- 2.5mm 304 stainless steel griddle splash guards
- Stainless steel spill trays

Bench mount (supplied as -B model)

- Four 63mm dia. heavy-duty 1.2mm 304 stainless steel bench legs with adjustable feet
- Adjustable height 80mm – 105mm

Controls

- Variable high to low controls to open burners
- Open burners flame failure standard with pilot burners optional
- Variable high to low controls to griddles
- Griddles standard with pilot, flame failure and piezo ignition
- Large easy use control knob - heat resistant reinforced
- Easy view control settings on knob

Cleaning and Servicing

- All models with easy clean stainless steel external finish
- Lift off burner heads and vitreous enamelled burner spill covers
- Stainless steel spill trays under open burner and griddle section
- Access to all parts from front of unit

Technical data sheet for GAS COOKTOPS 300mm

Specifications

Burners

Open Burners 28MJ/hr dual flame ring with simmer rate

Griddle Burners 20MJ/hr

Gas power

G512D 56 MJ/hr, 15.5kW

G512C 20 MJ/hr, 5.5kW

Griddle Plate

300mm Griddle cooking surface
292mm x 475mm, 1387cm²

Gas connection

R 1/2 (BSP) male

All units supplied with Natural and LP gas regulator

Dimensions

Width 300mm

Depth 812mm

Height 315mm

Incl. splashback 485mm

Nett weight

47kg

Packing data

0.20m³, 70kg

Width 870mm

Depth 350mm

Height 665mm

Gas types

Available in Natural gas and LP gas, please specify when ordering

Units supplied complete with gas type conversion kits

Other gas types on request

Options

Simmer plates (replaces Potstand)

Ribbed griddle

G512

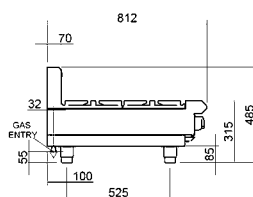
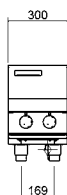

G512D-B



G512C-B

