

GE

Compact Sanitising Glasswasher - 365mm Rack

W 440mm x D 510mm x H 775mm

High speed sanitising glasswasher.

Standard Features

- Less than 5 litres per cycle water consumption
- Up to 1000 glasses per hour
- Electromechanical controls
- Rapid 1 minute cycle
- Selectable cold rinse
- Automatic detergent dosing
- 3 kW rinse
- Flush front
- 290mm high wash chamber clearance
- Suits 365mm x 435mm racks
- Removable rack slide
- Robust stainless construction
- Fits 560mm bench depth
- 150mm legs supplied
- Watermark certified
- No commissioning required

Accessories

- 1 x KO401 - 365mm x 435mm glass rack
- 2 x Water supply hoses included



The unit shall be a Washtech glasswasher with Watermark certification. The glasswasher shall have a one minute complete operating cycle including operator selectable cold final rinse. The unit shall accept racks 365mm x 435mm square with 290mm door clearance for tall glasses. A detergent injector shall be fitted and the unit shall be supplied in 100% recyclable shipping packaging. Electrical supply to be 15 amp single phase.

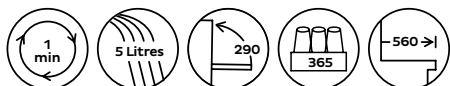

WASHTECH®

PROFESSIONAL WASH SYSTEMS

GE

Compact Sanitising Glasswasher - 365mm Rack

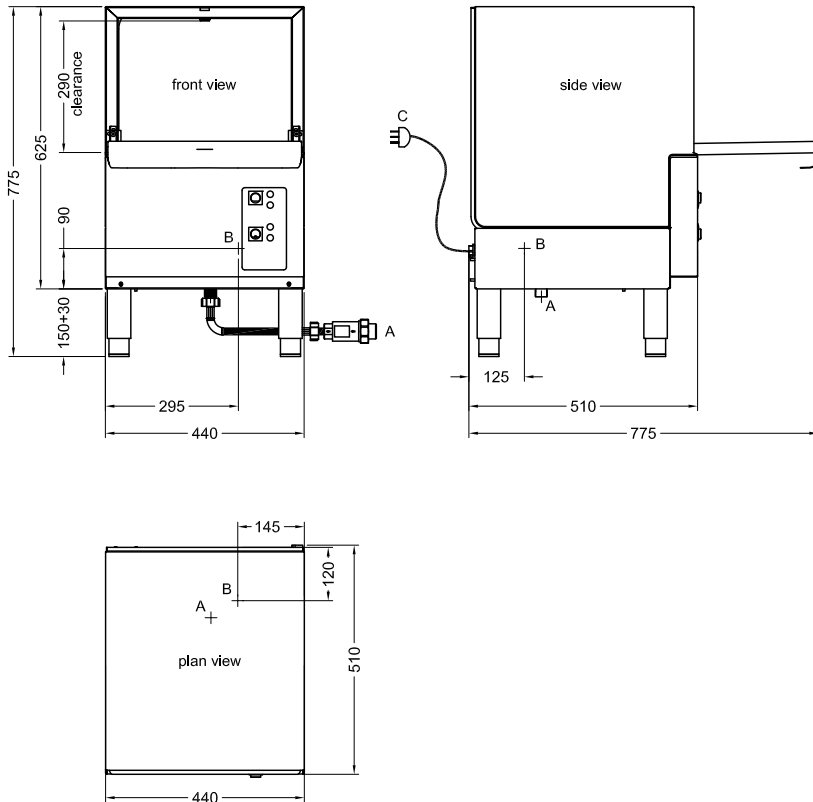

A Hot Water

temperature	65°C
connection	3/4" hose supplied
pressure	200-350kPa
flow	20 litres per min
quality	potable & soft

B Waste

connection	1.5 BSP
line	2" BSP

C Electrical

Single phase 240V 50Hz	15 amp plugset supplied
------------------------	----------------------------

D Cold Water

cold - otherwise as per hot

Refer operator manual for complete
installation instructions

Dimensions

Width	440mm
Depth	510mm
Height	775mm
Weight	26kg

Packed Dimensions

Width	505mm
Depth	575mm
Height	775mm
Weight	38kg
Cubicmetres	0.25m ³



Australia
www.moffat.com.au

Australia
Moffat Pty Limited

Victoria/Tasmania
740 Springvale Road
Mulgrave, Victoria 3170
Telephone 03-9518 3888
Facsimile 03-9518 3833
vsales@moffat.com.au
www.moffat.com.au

New South Wales
Telephone 02-8833 4111
nswsales@moffat.com.au

South Australia
Telephone 03-9518 3888
vsales@moffat.com.au

Queensland
Telephone 07-3630 8600
qldsales@moffat.com.au

Western Australia
Telephone 08-9202 6820
bgarcia@moffat.com.au



ATS 1200 101
Cert 010093
SAS 010044

