

WASHTECH®

PROFESSIONAL WASH SYSTEMS

M2C

High Efficiency Professional Passthrough Dishwasher - 500mm Rack

W 705mm x D 765mm x H 2040mm

The M2C is fitted with a Heat Recovery Condensor which uses exhaust air to heat incoming water – washes up to 1000 plates per hour on cold water supply.

Standard Features

- Heat Recovery Condensor preheats cold water supply
- Significant reduction of steam emitted
- Suitable for installation without canopy in many situations – with good general dishroom ventilation.
- 2.6 litres per cycle cold water consumption
- Up to 1000 plates per hour
- Electronic controls with enhanced functionality
- Multi-cycle options – 1, 2 and 3 minute cycles with manual cycle mode, Ecopower, Soft Start and Self rinsing cycle
- Service diagnostics for error recognition
- Double filtration via scrap trays and separate wash inlet filter
- Dual chemical injectors and Drain pump fitted standard
- Stainless steel upper & lower wash & rinse arms with removable cleaning caps
- 10kW electrical load reducible to 7kW
- 430mm door clearance
- Autostart on hood closure - anti-drip door edge channels water away from operator
- Easy clean L-shaped tank with curved corners
- Stainless steel construction
- Assured final rinse - 316 stainless break tank & rinse booster
- QuickConnect
 - Water supply hose
 - Dual chemical injector lines
 - Drain pump outlet hose
- Corner or in-line installation
- Unique 595mm or 640mm bench gap installation option
- No commissioning required
- Watermark certified

Includes:

- 2 x 6007028 - 500mm dish rack
- 1 x 6007029 - 500mm cup rack
- 2 x C660503 - cutlery containers



The unit shall be a Washtech passthrough dishwasher with Watermark certification, suitable for in-line or corner installation. The unit shall be fitted with a heat recovery condenser and have automatic fill and low level wash pump and element protection and start automatically on door closure. It shall be fitted with electronic controls and keypad with operator selectable 1, 2 and 3 minute complete operating cycles. Door clearance shall be 430mm. The unit shall be fitted with upper and lower independent stainless steel wash and rinse arms, all with removable end plugs for cleaning. The unit shall be fitted with 0.75kW wash pump and cold water consumption shall be 2.6 litres per operating cycle. The unit shall require 15 amps per phase three phase 5 wire supply. The unit shall be supplied with 500mm cup and dishracks and shipped in 100% recyclable packaging. Height of machine shown includes leg adjustment of plus or minus 50mm.



WASHTECH®

PROFESSIONAL WASH SYSTEMS

M2C

High Efficiency Professional Passthrough Dishwasher – 500mm Rack

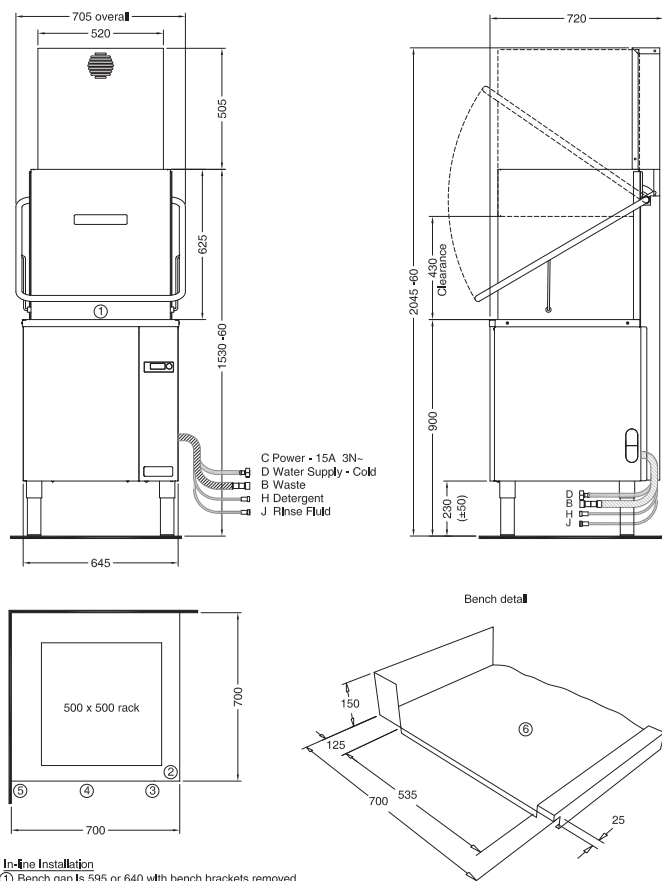

In-line Installation

① Bench gap is 595 or 640 with bench brackets removed

Corner Installation

② wall to front inside corner of wash tank 700

③ machine must face left for access to controls

④ allow 300 clearance beneath bench to front for service access

⑤ splashback return no higher than 150

⑥ left side is mirror image

D Cold Water

temperature Less than 20°C
 connection 3/4" male;
 hose supplied
 pressure 200-350kPa
 flow 15 litres per min
 quality potable & soft

B Waste

connection hose supplied
 for 38mm open
 standpipe 700 high
 or connection to
 sink trap

C Electrical

3 phase 415V 50Hz 15A/phase
 (10kW reducible to 7KW)

Dimensions

Width 705mm
 Depth 765mm
 Height 2040mm
 Weight 118kg

Packed Dimensions

Width 755mm
 Depth 825mm
 Height 1970mm
 Weight 142kg
 Cubicmetres 1.23m³

Refer operator manual for complete installation instructions



Australia
www.moffat.com.au

Australia
 Moffat Pty Limited

Victoria/Tasmania
 740 Springvale Road
 Mulgrave, Victoria 3170
 Telephone 03-9518 3888
 Facsimile 03-9518 3833
vsales@moffat.com.au
www.moffat.com.au

New South Wales
 Telephone 02-8833 4111
nswsales@moffat.com.au

South Australia
 Telephone 03-9518 3888
vsales@moffat.com.au

Queensland
 Telephone 07-3630 8600
qldsales@moffat.com.au

Western Australia
 Telephone 08-9202 6820
bgarcia@moffat.com.au

