

Three Glass Door Bottom Mount Upright Fridge

Series: ActiveCore

Dimensions: 1640 mm (W) × 795 mm (D) × 2005 mm (H)

Capacity: 1344 L

Project: _____

Item #: _____



A high-efficiency, bottom-mounted, heavy duty, 3-door display fridge suitable for front and back-of-house applications including restaurants, cafés, clubs, pubs, bars, quick service restaurants, and more. Made from powder-coated, galvanised steel, the cabinet comes complete with twelve adjustable height wire shelves and three stainless steel fixed shelves, easily adjustable via SKOPE's unique ezi-clip and numbered shelf supports. The "frameless" glass doors provide maximum product viewing and are designed for condensation protection in most environments via the double-glazed, argon-filled, low-e, insulated panels. The high impact built-in LED lights can be timed to turn on and off according to your opening times via the free SKOPE-connect smartphone app. With M1 compliance, the fridge is engineered to store food and drinks at a standard 1°C to 4°C (adjustable up to 15°C). It is certified under GEMS to the mandatory climate class 3 and is fully tested to operate in ambient environments of up to 40°C (climate class 5). The fridge uses R290 natural refrigerant for ultra-low energy consumption, low heat discharge, and low noise output. The bottom-mounted, fully removable, modular refrigeration cartridge can be easily removed in line with best practice for safe servicing of flammable refrigerants. With the same cartridge being used in both top and bottom-mounted fridges, you achieve the fastest possible servicing times with minimal business disruption. The fridge includes a smart controller that connects to the free SKOPE-connect app, enabling you to set temperatures and alerts, monitor temperatures and energy, and more. The fridge is certified to all Australian and New Zealand refrigeration and electrical safety standards.



Warranty



ActiveCore Technology



Natural Refrigerant



GEMS



SKOPE-connect

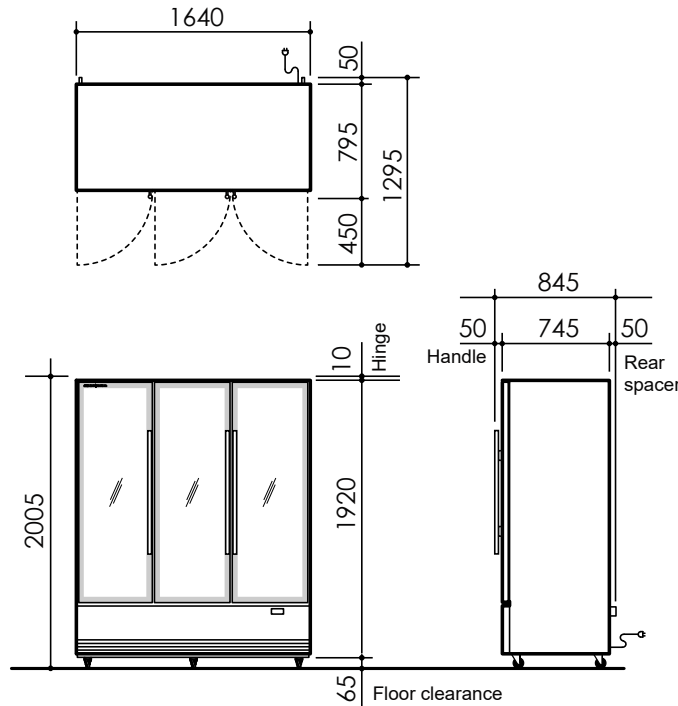

Cabinet

Range	BME		
Finish	Powdercoated galvanised steel or stainless steel		
Insulation	Type	PU foam	
	Thickness (mm)	50	
	Blowing Agent	Cyclo-iso pentane (C5H10/C5H12)	
Doors	Type	Glass swing door (double-glazed, single low-e, argon-filled, toughened, safety glass), tab-locking	
	Opening Size	Height (mm)	1455
		Width (mm)	415
Shelving	8 × adjustable height outer shelf (490W × 520D), 4 × adjustable height inner shelf (540W × 520D), 2 × solid bottom outer shelf (485W × 515D), 1 × solid bottom inner shelf (545W × 515D)		
Lighting	Sign	n.a.	
	Interior*	3 × 1370 mm 15 W LED strips	

Dimensions†

	External	Internal	Packed
Width (mm)	1640	1540	1655
Depth (mm)	795	600	815
Height (mm)	2005 (castors)	1455	2200
Weight (kg)	310		317
ANSI Volume (L)	1344		
Footprint (m²)	1.3		

Ventilation (mm)

Top	Sides	Rear
50	Not required	50

Product Loading

	330 ml can	660 ml bottle
Facing	110	95
Loading	735	630

Dimensional Tolerances

† Allow for dimensional tolerances when installing the cabinet(s).

Linear dimensions	Single cabinet	Multiple cabinets	
		At each joint	At each end wall
Less than 1 metre	±5 mm	±5 mm	+15 mm
More than 1 metre	-5 mm to +10 mm	-5 mm to +10 mm	+15 mm

Performance

Product Temperature Range (°C)*	1 to 5 (adjustable 1 to 15)
Maximum Ambient Temperature (°C)	40
Sound Power Level (dB(A))	60

Greenhouse and Energy Minimum Standards (GEMS)

Star Rating	8
Product Temperature Class	M1
Total Energy Consumption	5.09 kWh/24 h
Annual Running Costs	\$557 (@ \$0.30/kWh)

Electrical

Supply	220 to 240 volts a.c., 50 Hz, single phase supply
Cord	1.85 m power cord with 3-pin, 10 amp plug
Current draw (A)	2.0

Refrigeration

Controller	SCS Connect (SKOPE-connect compatible)
System Type	Removable cartridge
Cartridge Weight (kg)	28
Refrigerant/Charge	R290/99 g
Nominal Capacity (W)	547
Heat Rejection (W)	Average 225 Peak 260
Defrost Type	Automatic, off-cycle
Drainage	No plumbing required

* Controllable via SCS Connect.



BME1500N-A
on the SKOPE website