

2/4 Burner Gas Boiling Tops

The Elco 700HP range is comprised of over 100 models designed to guarantee the highest level of performance, reliability, energy saving, safety standards and ergonomic operation. These concepts are reflected in the total modularity of the range that ensures numerous configurations, either free-standing or bridged. Elco 700HP demonstrates how advanced technology can satisfy the needs of the professional caterer. The models detailed on this sheet are 2 and 4 burners gas boiling tops.



178600

EASY TO INSTALL

- All top models are provided with a service duct to facilitate installation and can be mounted on open base cupboards or bridging supports.
- Main connections can be accessed via the rear or the base of the unit.

EASY TO CLEAN

- One piece pressed worktop in 1,5mm 304 AISI stainless steel with smooth, rounded corners.
- Front panel in 304 AISI stainless steel with Scotch Brite finish.

- All models have right-angled, laser cut side edges to allow flush-fitting joins between units eliminating gaps and possible dirt traps.
- Pan supports are cast iron.

EASY TO USE

- High efficiency flower flame allows for the flame to be adapted in order to permit pots of different sizes to be used.
- Burners:
 - Interchangeable on site.
 - Flame failure.
 - 5,5 kW with flame regulator.
 - Pilot light for each burner.

- All gas appliances are supplied for use with natural gas, LPG or town gas. Conversion jets supplied as standard.
- Optional smooth or ribbed accessory plates may be placed directly on the burners, allowing for food such as steaks, hamburgers, fish and vegetables to be cooked to perfection.

EASY TO MAINTAIN

- IPX4 water protection.

EASY ON THE ENVIRONMENT

- 98% recyclable by weight.
- CFC free packaging.



Electrolux

Elco 700HP
2/4 Burner Gas Boiling Tops

	QCG400 178600	QCG800 178601
TECHNICAL DATA		
Power supply	Gas	Gas
External dimensions - mm		
width	400	800
depth	730	730
height	250	250
Back burner dimensions - mm	Ø 60	Ø 60, Ø 60
Back burners power - kW	5.5	5.5, 5.5
Front burners dimension - mm	Ø 60	Ø 60, Ø 60
Front burners power - kW	5.5	5.5, 5.5
Power - kW		
gas	11	22
Net weight - kg.	20	38
ACCESSORIES		
2 SIDE COVERING PANELS FOR TOP-D=700MM	216277	216277
CHIMNEY COVER 400MM CLOSED	206269	
CHIMNEY COVER 800MM OPEN-SMALL CHIMNEY		206272
DOUBLE BURNER RIBBED PLATE	921685	921685
DOUBLE BURNER SMOOTH PLATE	921684	921684
FRONTAL HANDRAIL 1200 MM	216049	216049
FRONTAL HANDRAIL 1600 MM	216050	216050
FRONTAL HANDRAIL 400 MM	216046	216046
FRONTAL HANDRAIL 800 MM	216047	216047
LARGE HANDRAIL(PORTIONING SHELF)400 MM	216185	216185
LARGE HANDRAIL(PORTIONING SHELF)800 MM	216186	216186
PRESSURE REGULATOR FOR GAS UNITS	927225	927225
RIGHT AND LEFT SIDE HANDRAILS	206240	206240
SINGLE BURNER RADIANT PLATE	206264	206264
SINGLE BURNER RIBBED PLATE	206261	206261
SINGLE BURNER SMOOTH PLATE	206260	206260
SUPPORT FOR "BRIDGE" SYSTEM 1000 MM	206138	206138
SUPPORT FOR "BRIDGE" SYSTEM 1200 MM	206139	206139
SUPPORT FOR "BRIDGE" SYSTEM 1400 MM	206140	206140
SUPPORT FOR "BRIDGE" SYSTEM 1600 MM	206141	206141
SUPPORT FOR "BRIDGE" SYSTEM 400 MM	206154	206154
SUPPORT FOR "BRIDGE" SYSTEM 800 MM	206137	206137
WATER COLUMN WITH SWIVEL ARM	206266	206266

CGAA010

2007-07-30

Subject to change without notice

Elco 700HP
2/4 Burner Gas Boiling Tops

178600

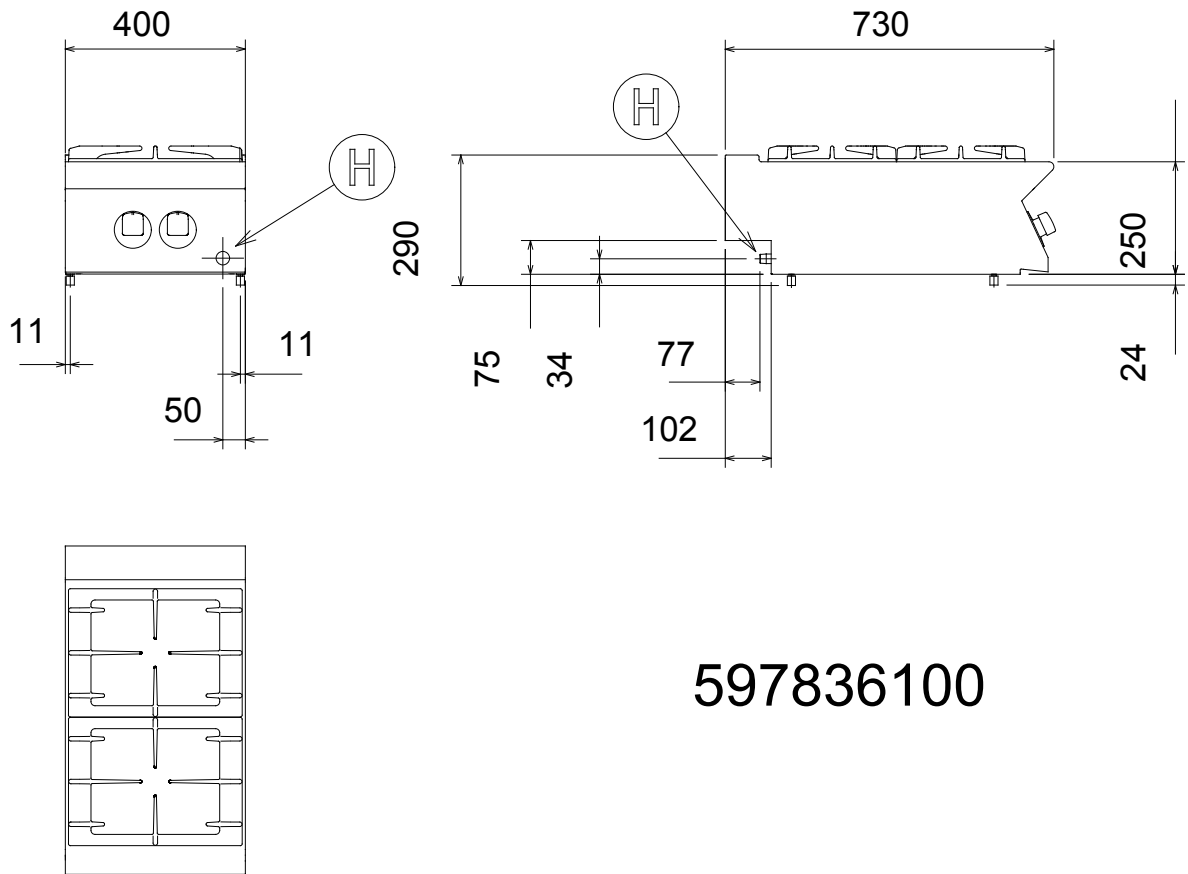

597836100

LEGEND
H - Gas connection

QCG400
178600

1/2"

CGAA010

2007-07-30

Subject to change without notice

Elco 700HP
2/4 Burner Gas Boiling Tops

178601

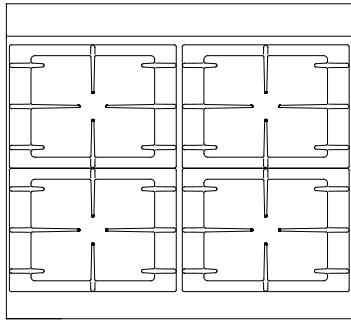
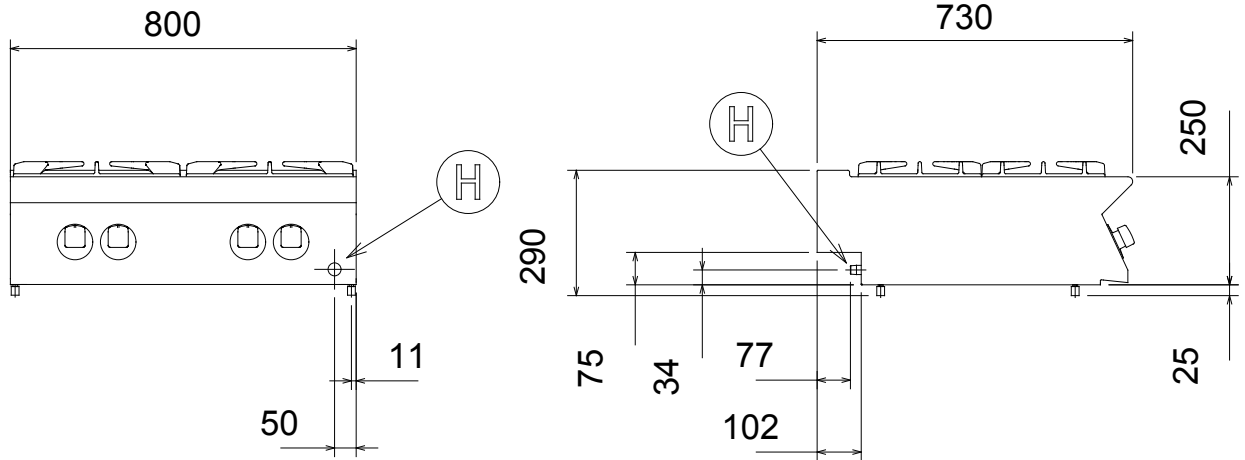

5978362 00

LEGEND
H - Gas connection

QCG800
178601

1/2"

CGAA010

2007-07-30

Subject to change without notice