



PROJECT	
ITEM	
QUANTITY	
DATE	

Designed to fit under the base system of Anets 14GS.CS fryers, the large filter capacity allows this system to be used with up to four Anets 14GS.CS fryers. Using quick disconnects, the filter is simple to disassemble for cleaning.

Filter intake leaves no oil residue in the tank. Easy to identify handles make filtering a simple process. Filter one fryer while cooking in the others. Promotes longer oil life and a consistent high-quality product.

FEATURES & BENEFITS:

- Filtermate system with renowned 14GS.CS open fryers banked together
- Millivolt control - 3 fryer filter drawer system
- Automatic hands free filtering
- Large filter machine designed to hold 50 filters of oil
- Filter machine slides out and can double up as a portable filter
- Filtermate has an oil bypass system, allowing oil to be pumped out of the filter with the discharge hose
- All filtration systems come standard on adjustable height castors, Washdown/discharge hose, Box of 100 envelope papers, Starter sample pack of filter powder, Lids, Clean out rod and brush
- **10 year warranty on stainless steel frypot**

TECHNICAL DATA:

Dimensions (W x D x H):	1191 x 790 x 1160
Total Weight:	314Kg
Cooking Area (W x D x H):	356 x 356 x 122mm (x3)
Oil Capacity:	20-22 Litres per tank

GAS DETAILS	Natural Gas (NG)	Universal LP Gas (ULPG)
Minimum Supply Pressure	1.7 kPa	2.74 kPa
Operating Pressure	1.0 kPa	2.5 kPa
Total Gas Supply	378MJ/Hr	378MJ/Hr

3/4" BSP connection

NOTE: It is the responsibility of the installing gas plumber to ensure correct supply and connection sustaining appropriate pressure when all appliances are full on.
240 Volt 10Amp connection required to run filter system.

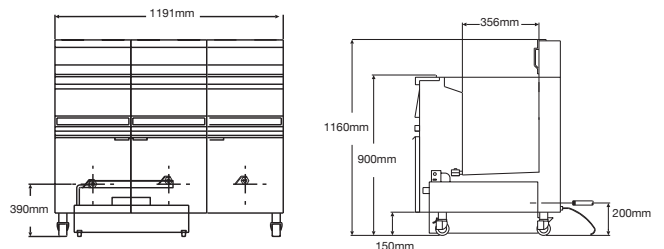
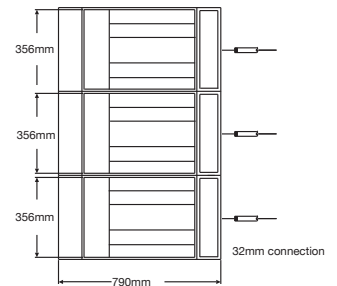

Due to continuous product research and development, the information contained herein is subject to change without notice.
Revision: 16/7/2020

www.stoddart.com.au
www.stoddart.co.nz