

**WARRANTY 3 YEARS**  
PARTS & LABOUR



**Turbo air**

**NSW & VIC Rebate Eligible**

## BACK BAR

**Fridge**  
**TBB-3SGD**

### FEATURES / BENEFITS

- **EFFICIENT REFRIGERATION SYSTEM**  
Turbo Air's refrigerators are designed with oversized and balance refrigeration systems. These include efficient evaporators and condensers for faster cooling and greater efficiency.
- **FORCED AIR COOLING SYSTEM**  
Fast cooling and balanced temperature throughout the cabinet.
- **STAINLESS STEEL COUNTERTOP AND INTERIOR**  
The exterior of cabinet is constructed with heavy gauge reinforce stainless steel countertop and wear-resistant black vinyl coated galvanized steel. Interior is stainless steel floor and door liners w white painted galvanized steel inside walls. Turbo Air Back Bar m guarantees utmost in cleanliness and long product life. It also can add a touch of style to the most refined setting.
- **LED INTERIOR LIGHTING FOR ALL MODELS**  
Bright LED interior lighting is specifically designed for perfect visi throughout the interior.
- **HIGH DENSITY POLYURETHANE INSULATION**  
The entire cabinet structure is foamed-in-place using high density, CFC free polyurethane insulation.
- **ADJUSTABLE, HEAVY DUTY, PE (POLYETHYLENE) COATED WIRE SHELVES**
- **ERGONOMICALLY DESIGNED DOORS**  
Customers' fatigue fades away with easy grip handles and doors that open effortlessly. These features along with self-closing doors make this the ultimate choice in customer convenience.
- **SIDE MOUNT COMPRESSOR UNIT**  
By positioning the compressor on the side of the unit, refrigerators can now be serviced without being moved.



**TBB-3SGD**



#### Optional features

- 125mm castors fitte
- 180mm, 105mm, 80mm castors optiona
- Adjustable legs 100-155mm, 70-90m

REFRIGERATOR MANUFACTURER  
**Turbo air**

■ **WARRANTY: 3 Year Parts and Labour Warranty**

# BACK BAR

## Fridge TBB-3SGD

|   |   |
|---|---|
| Model   | TBB-3SGD                                |
| Refrigerant   | R-134a                                  |
| COMP (HP)   | 1/4HP                                   |
| POWER INPUT(W)  | 368W                                    |
| Energy consumption  |   |
| AMPS(A)   | 1.7                                     |
| Capacity  | 723                                     |
| Product Dimension W                                       | 1754                                    |
| Product Dimension D                                       | 692                                     |
| Product Dimension H                                       | 1066                                    |
| Weight  | 195                                     |
| Stainless steel   | EGI (BLACK)                             |
| Features  | SCC                                     |
| Max GN Pan depth  |   |
| GN Pan  |   |
| Door lock   | Yes                                     |
| Adjustable Shelves  | 6                                       |
| LED light   | yes                                     |
| Temperature range   | 0~10°C                                  |
| Ambient temperature                                       |   |
| Drainage / Forced Evaporation                             | Yes                                     |
| Temperature control                                       | Digital control                         |
| Cooling type  | FAN COOLING                             |
| Glass Type (Low-e / Heater / How many layer of the glass) | Double Pane Glass Door with Low-E glass |

Design and specifications subject to change without notice.  
Actual Shipping weight may differ due to extra packing materials for product protection.

- DOOR LOCKS STANDARD
- SELF-CONTAINED SYSTEM
- 4" SWIVEL CASTERS STANDARD

**WARRANTY 3 YEARS**  
PARTS & LABOUR



### PLAN VIEW

(unit : mm)

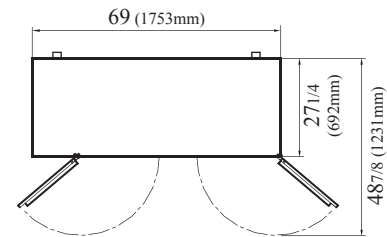
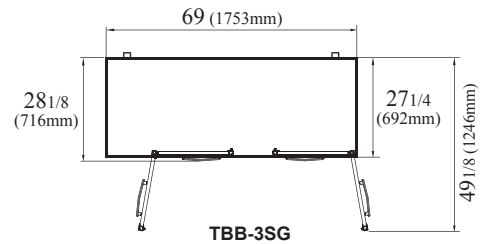

### PLAN VIEW

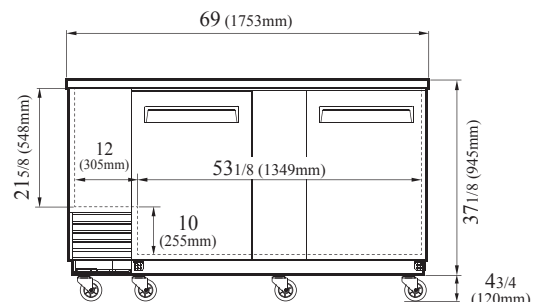

### FRONT VIEW

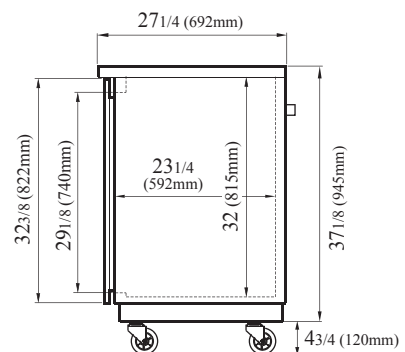

### SIDE VIEW

## AUSTRALIA BRANCH

TURBO AIR PTY LTD  
[www.turboairinc.com.au](http://www.turboairinc.com.au)  
 1st Floor, Building E  
 10 Highgate St, Auburn  
 NSW 2144 Australia  
 T. 02 9737 9881

**Turbo air**

email : TA.admin@turboairinc.com.au